

仮設校舎計画図（案）

資料 9

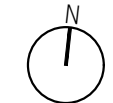
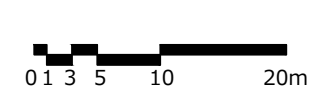
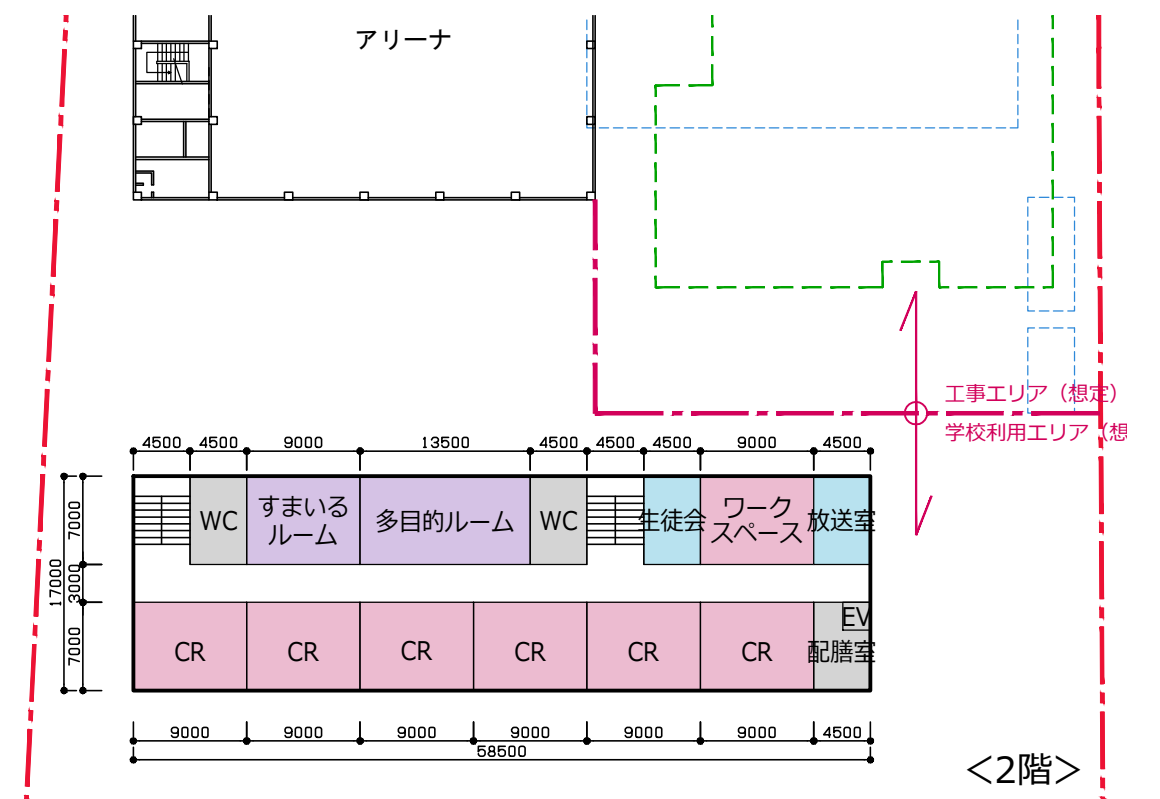
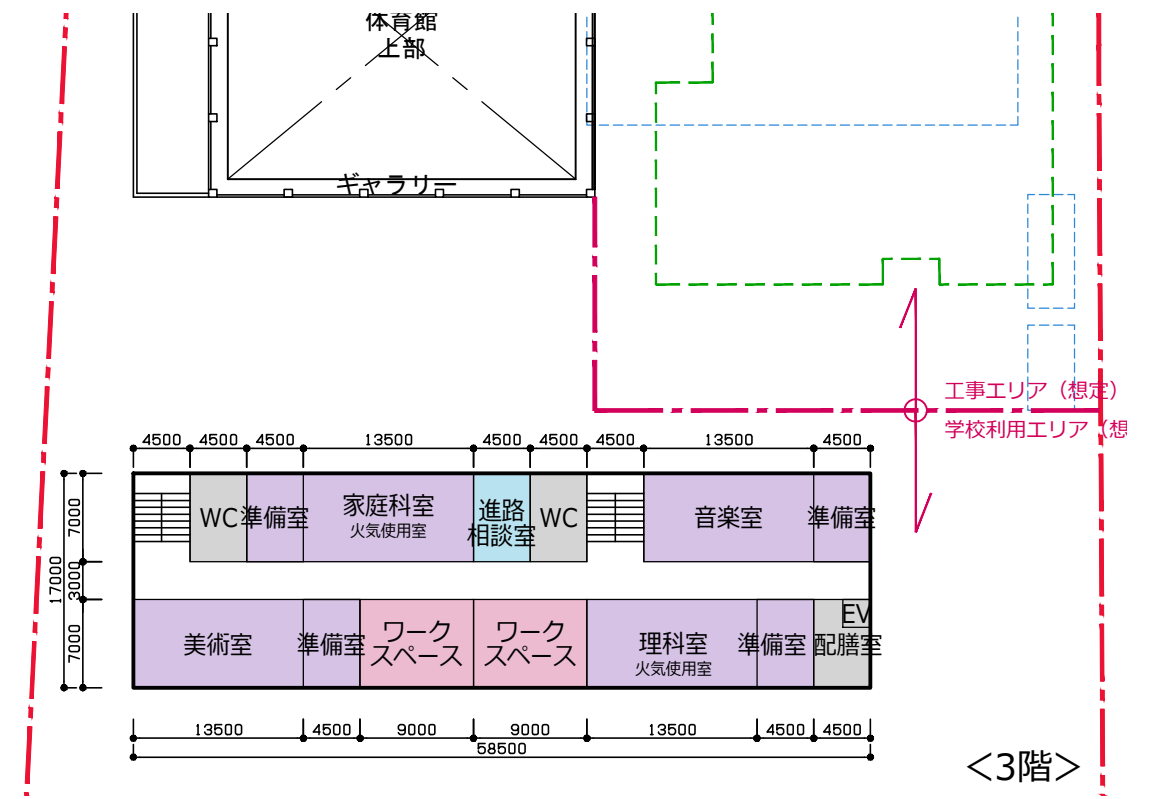
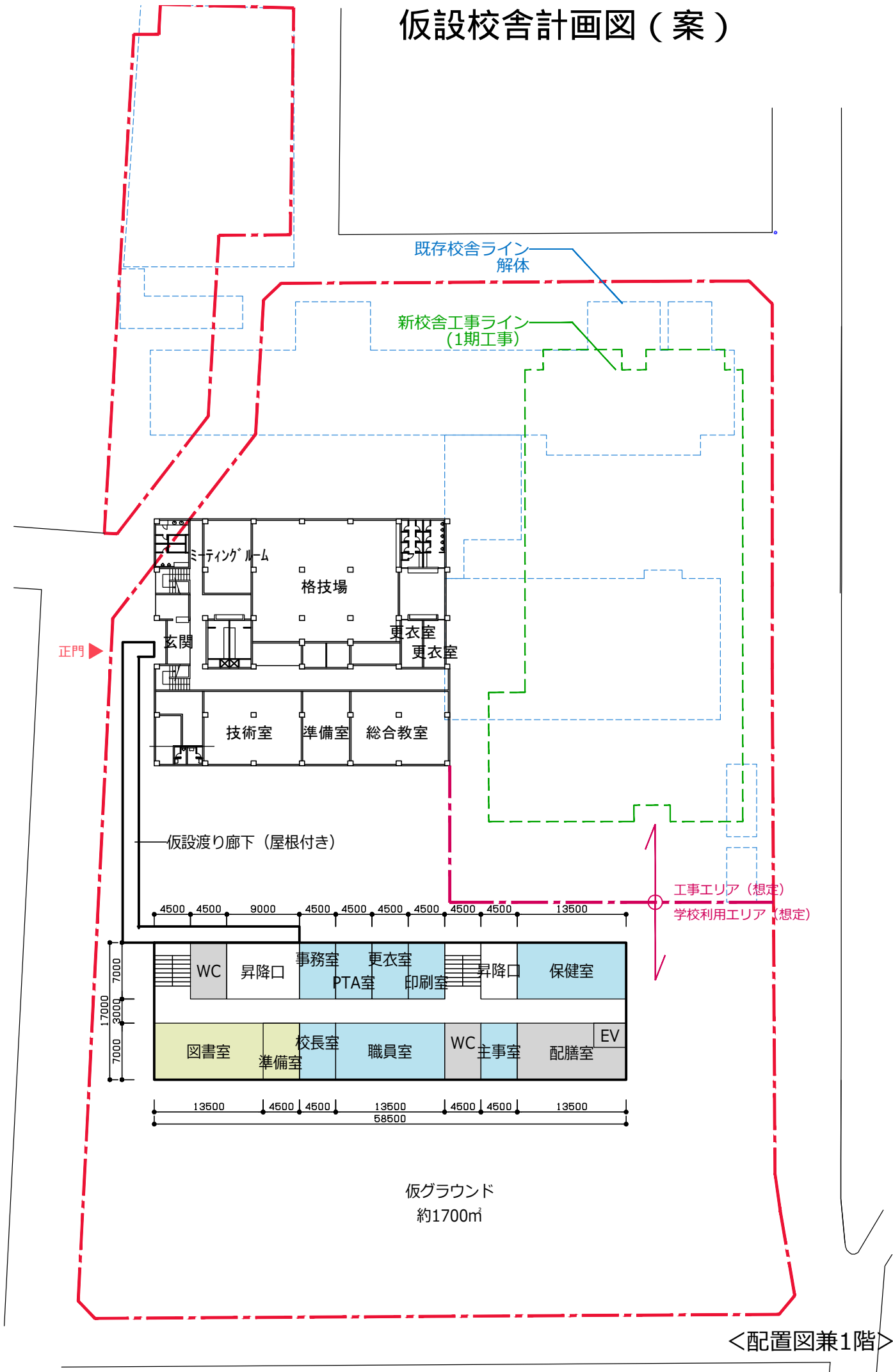

仮設校舎 ステップ2,3プラン

A3 1/600

仮設校舎計画図（案）

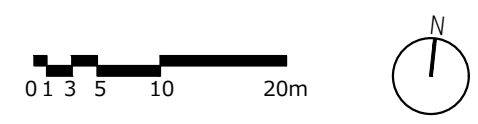
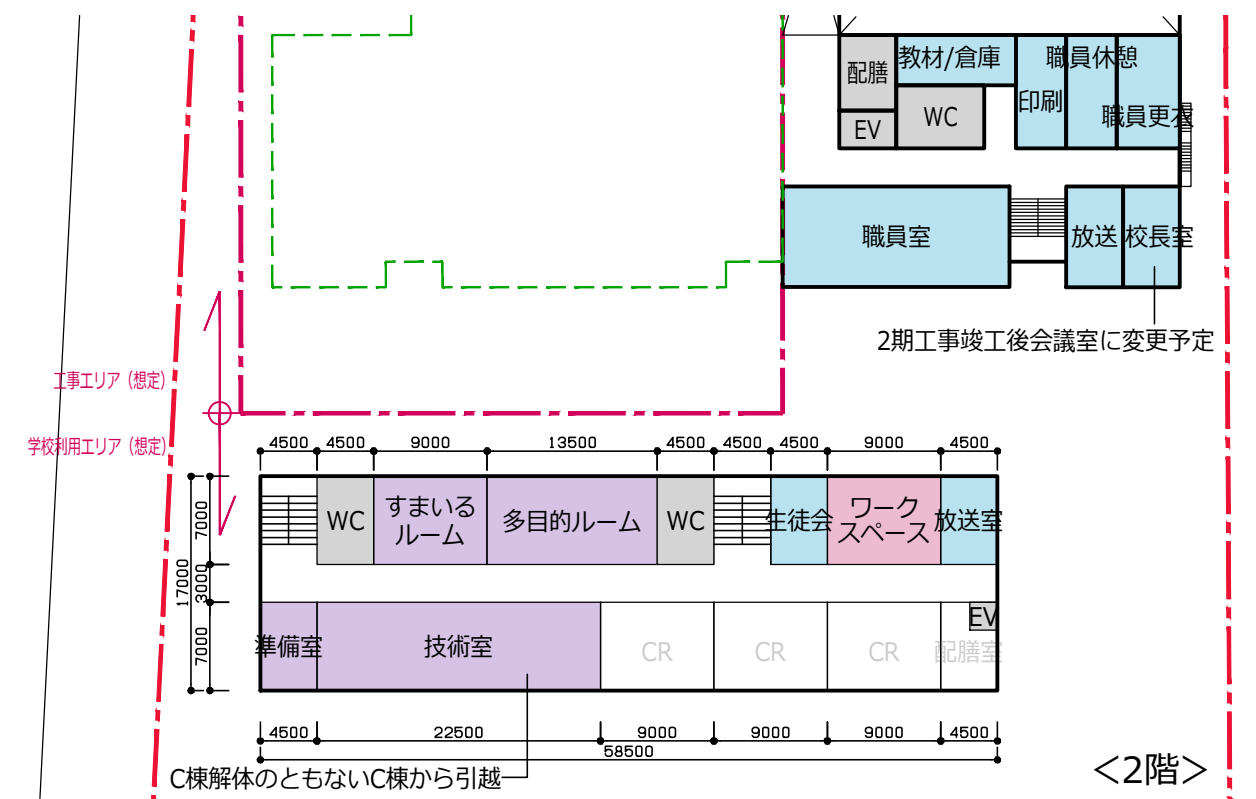
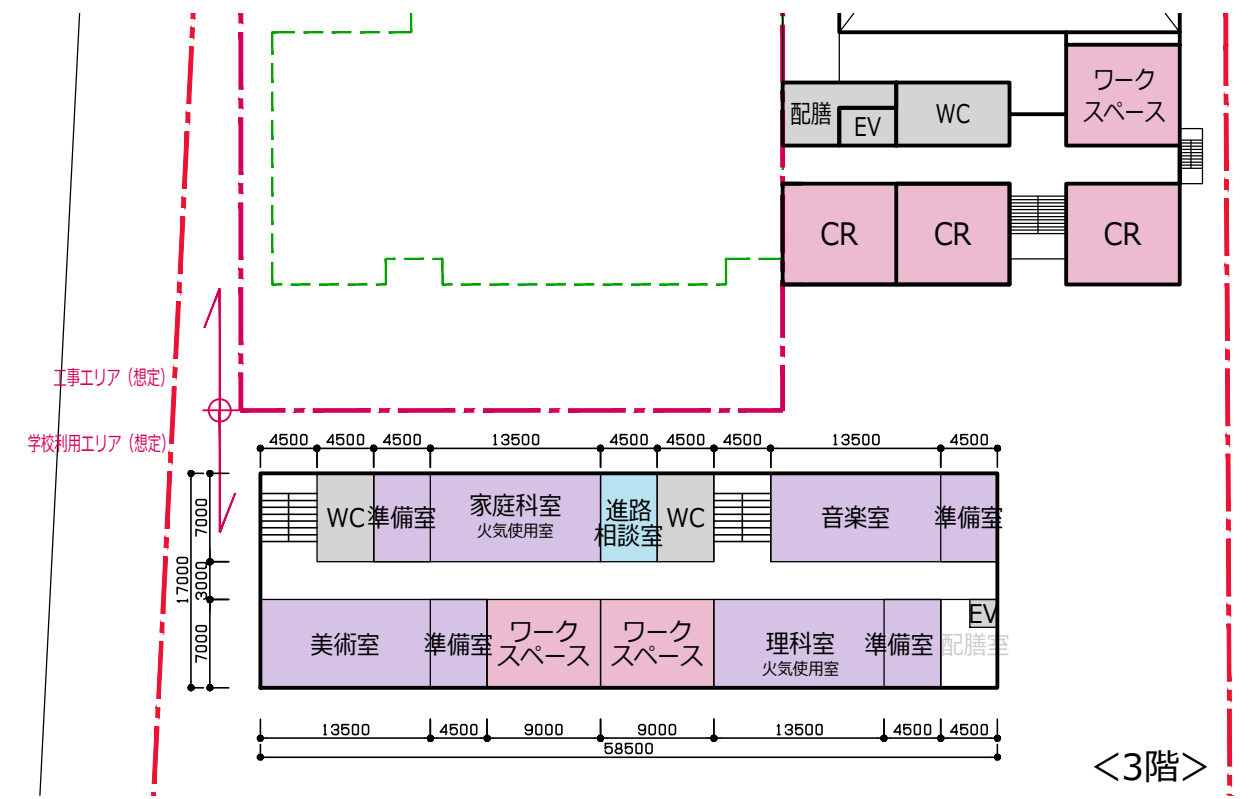



道路まわり外構整備イメージ

直近改築校の外構断面イメージ

他校の例です。奥沢中学校の設計図ではありません。

(2) 外構断面図

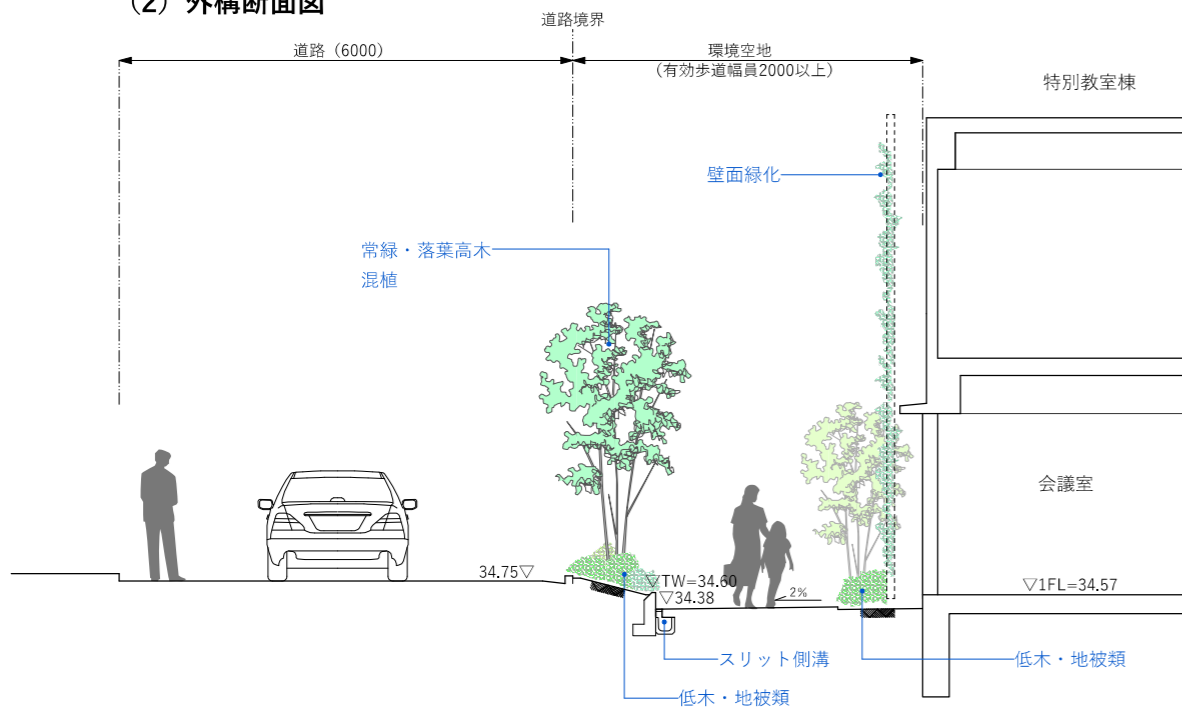

A 断面図 S=1:100 (西)

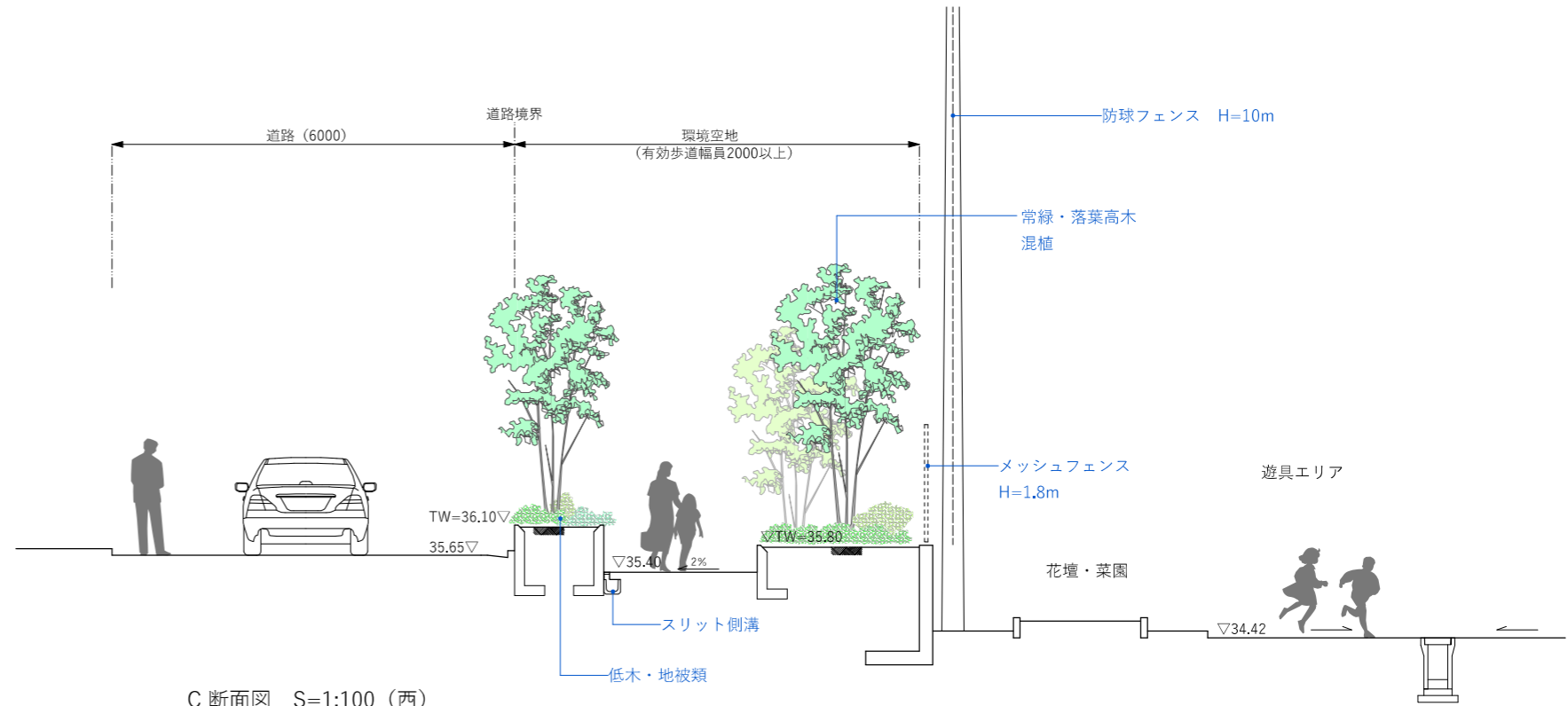

C 断面図 S=1:100 (西)

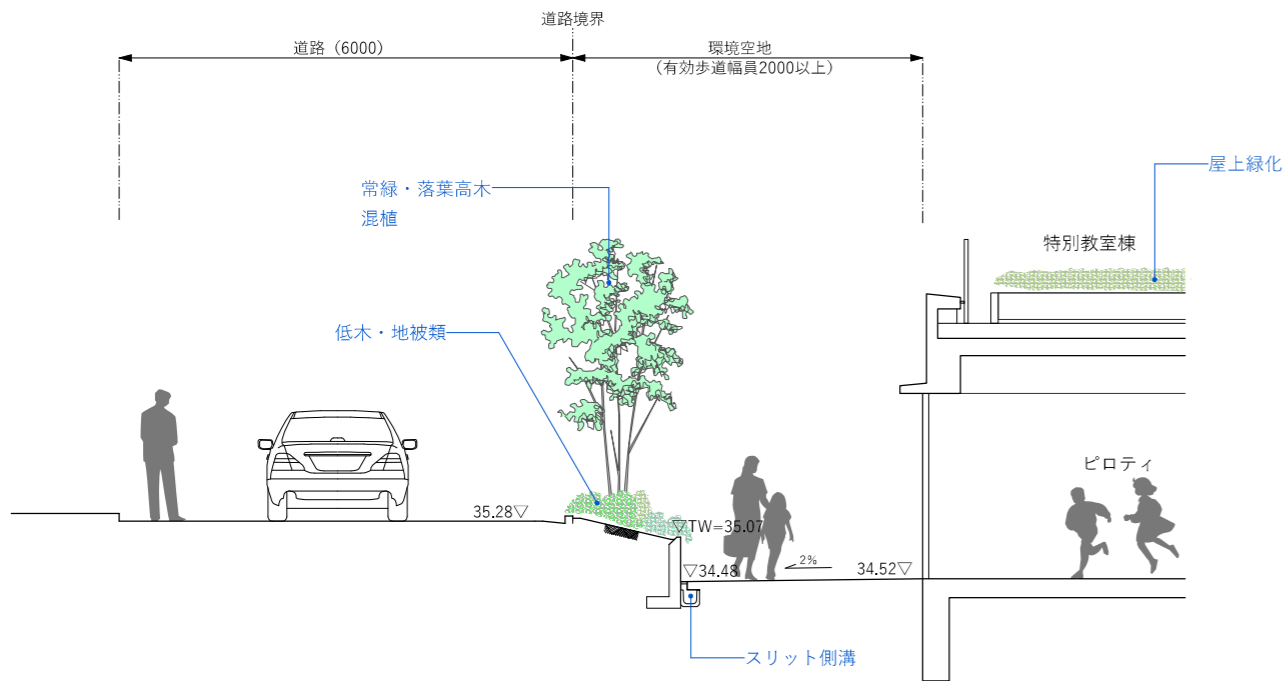

B 断面図 S=1:100 (西)

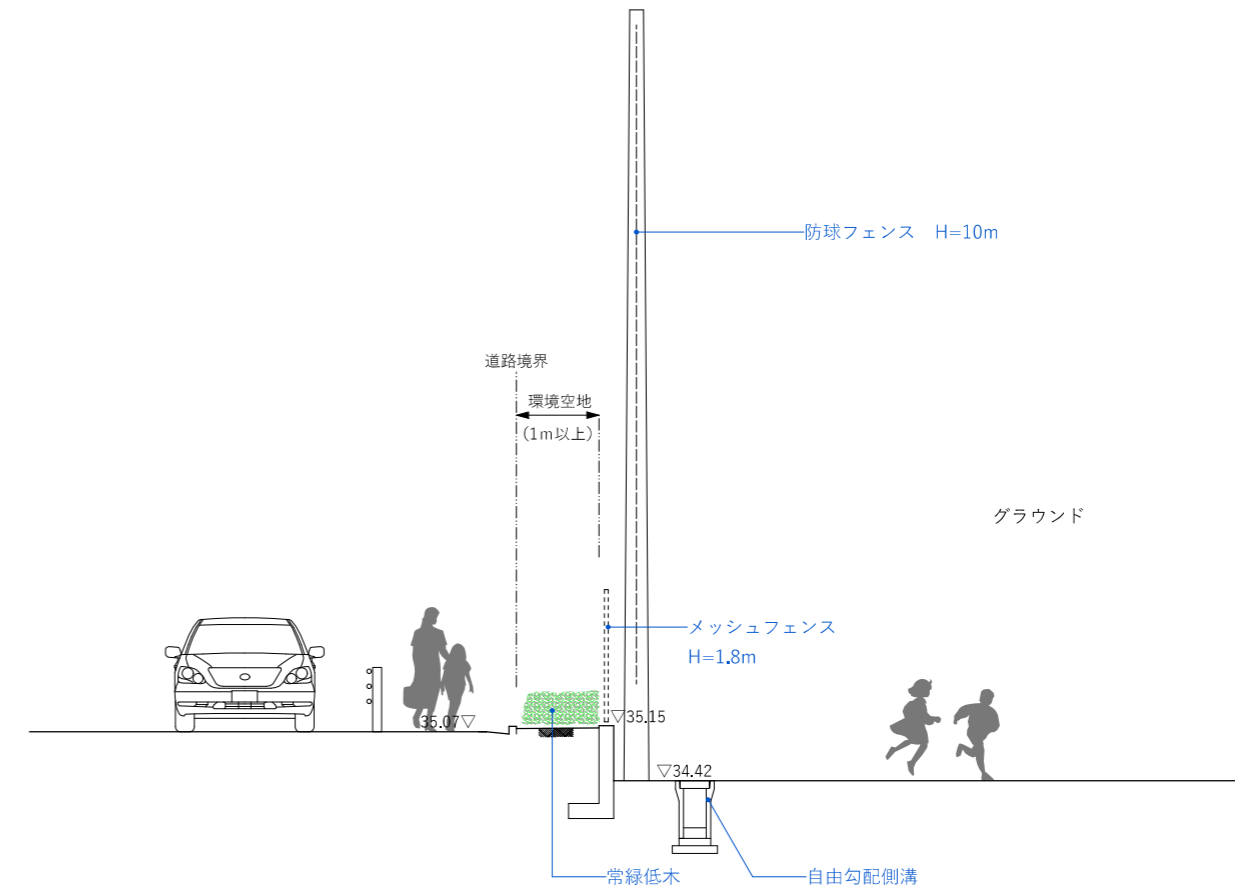

D 断面図 S=1:100 (南)